



TRIM – D17-44651

OrgTRx Quick Reference Guide – Displaying % non-susceptible

This document takes you through the steps to display the % non-susceptible rather than %S. Open a view you want to change (this example uses Antibiogram Blood)

1 Replace measures in the grid with sensitivity status code

1a Go to **Filters**

1b Select **All Slicers**

1c Click on the **+** sign beside Sensitivity Status

1d Select **Sensitivity Status Code**

1e Select **Apply**

1f Click on **Slicers** to return to the slicer pane

1g Click on the **dropdown arrow** beside **Measures** in the grid

1h Choose **Replace Measures with – Sensitivity Status Code**

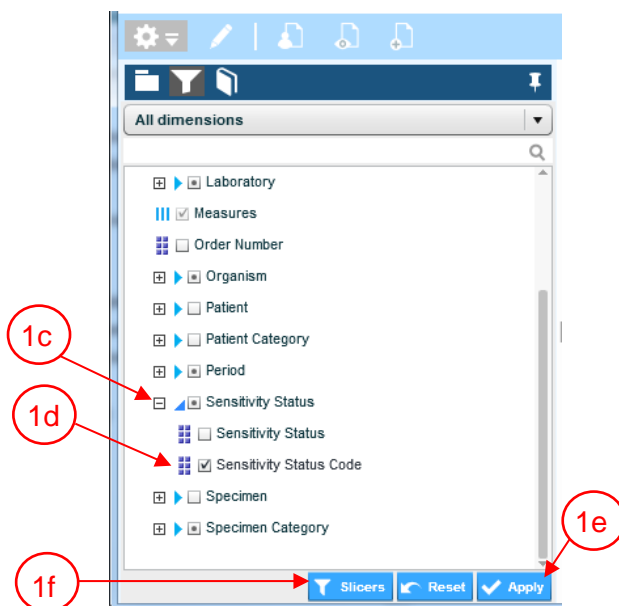
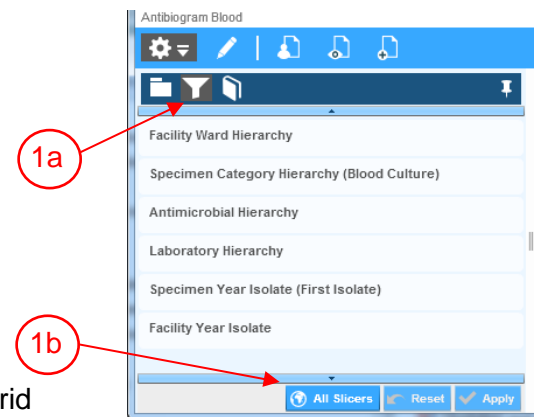

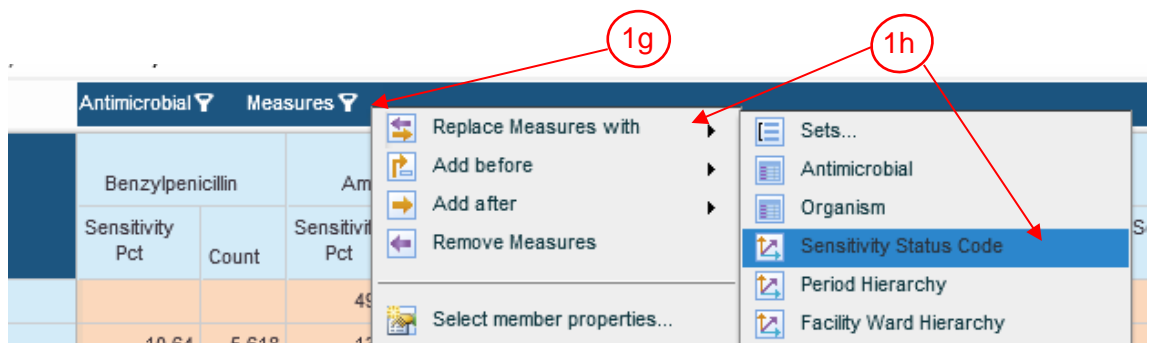

2 Create a formula for the non-susceptible count

2a Click **Maximise** button – icon in the top RH corner when you hover over the work board

You now have a slightly different looking pane on the LHS of your screen

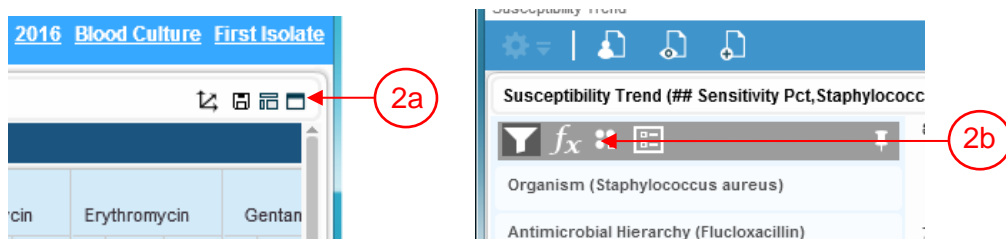

2b Click on the function button (**fx**)

2c Enter a **Formula name** (No. non susceptible) this will be the name of a new column created in the grid

2d Choose a **Formula format** this establishes the format for the display of the number created by the formula. Use **#,##0** which gives whole numbers with a thousands separator.

2e Choose a **Formula type - Sum**

2f Highlight and drag the members from the data grid that want to add up (**R & I**) into the **Items** box or use the members selection button on the RHS of the Items box to select members

2g Select **Apply** and a new column appears in the data grid called No. non susceptible

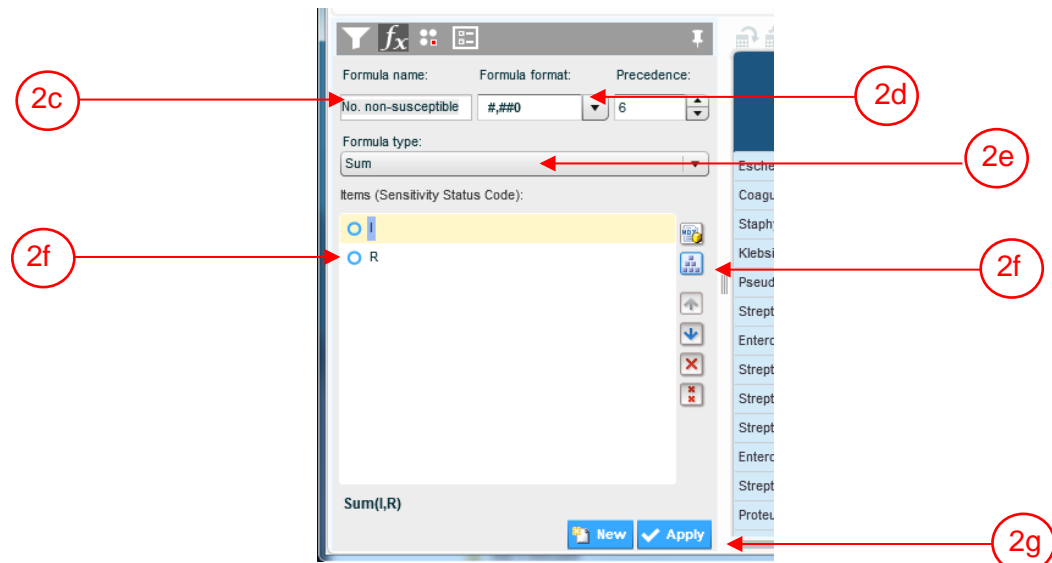

3 Create a formula for the total tested

3a Click **New** to create a new formula

3b Enter a **Formula name** (Total tested)

3c Choose the **Formula format** (#,##0)

3d Choose the **Formula type** - Sum

3e Highlight and drag the members from the data grid that you want to add up (eg. **S**, **I**, & **R**) to the **Items** box or use the members selection button on the RHS of the Items box to select members

3f Select **Apply** and a new column appears in the data grid called total tested

